

7. War memorabilia

The military uniform used for World War II, a helmet, the bucket made of cloth, a service bag, and the back is exhibited. In addition, the cultural property and scenic spot of Yomitan village are introduced with the map and the photograph. An audiovisual room is prepared and world heritage, the folk performing arts outside a village, and the data of an old tale are also offered according to a request of a visitor. Moreover, the plan exhibition is also performed.



8. Reference library

The library is 136.53 square meters and there are 22,851 books of historical folklore and other kinds of reference about Okinawa. There are 853 volumes of The Okinawa Times and Ryukyu Shimpo bound monthly since May 1968. All of the books are classified and available for reference use.



Information

M A P

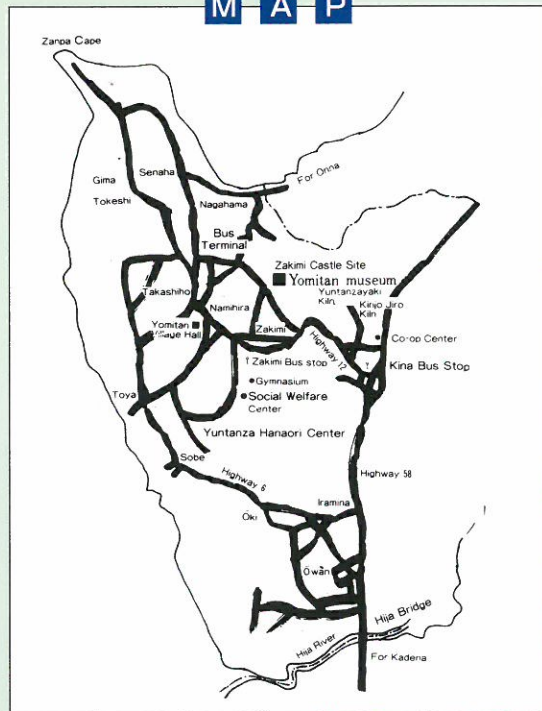

708-4 ZAKIMI
YOMITAN OKINAWA
Telephone 098-958-3141

Information

Open
9:00AM~17:00PM(admission until 16:30)
Closed
· Every Monday (Tuesday also in the case of holiday celebrated on Monday)
· National holiday
· New years holiday (December 29 to January 3)
· Preparatory days for exhibition changes
· June-23 (public holiday in Okinawa)
Admission Fee (Group rates-40 or more)
adults 200yen (160yen)
elementary middle
and high school students 50yen (40yen)

Stamp Please

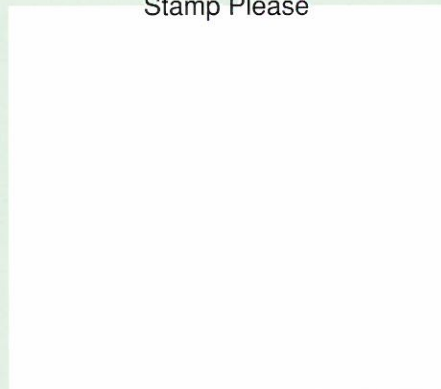

YOMITAN HISTORICAL & FOLK CRAFT MUSEUM EXHIBITION GUIDE



Commemorating the reversion of Okinawa to Japan, the property surrounding the ruins of Zakimi Castle was developed into a public park. In 1971, a folk art museum concept was added to the park plan and construction began in August 1974. The museum was opened in May 18, 1975. In

Okinawa, it received much attention and 40,000 items were collected during 51 years. Because exhibition and storage space was limited, further expansion was required and in 1988, construction of the new building was begun. By the end of March 1989, it was completed. The adjoining new three story reinforced concrete structure (1,959.795 square meters) effectively presents the history and folklore of Yomitan village.

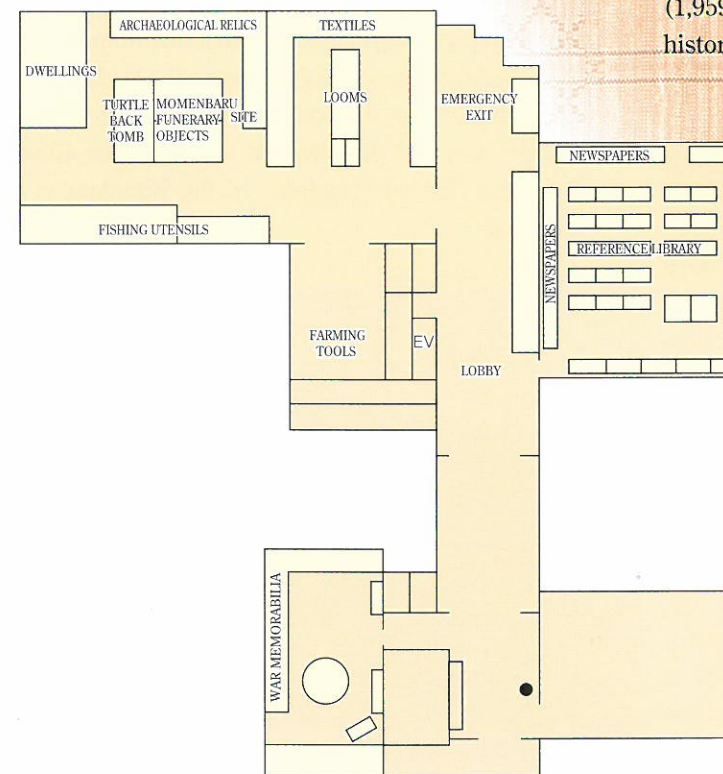

HISTORICAL AND
FOLK CRAFT EXHIBITION...389,451㎡
REFERENCE LIBRARY..... 136.53㎡
LOBBY..... 79.129㎡